

# JUNCTION WITH CHIMNEY IN STAINLESS STEEL ( between two seams )

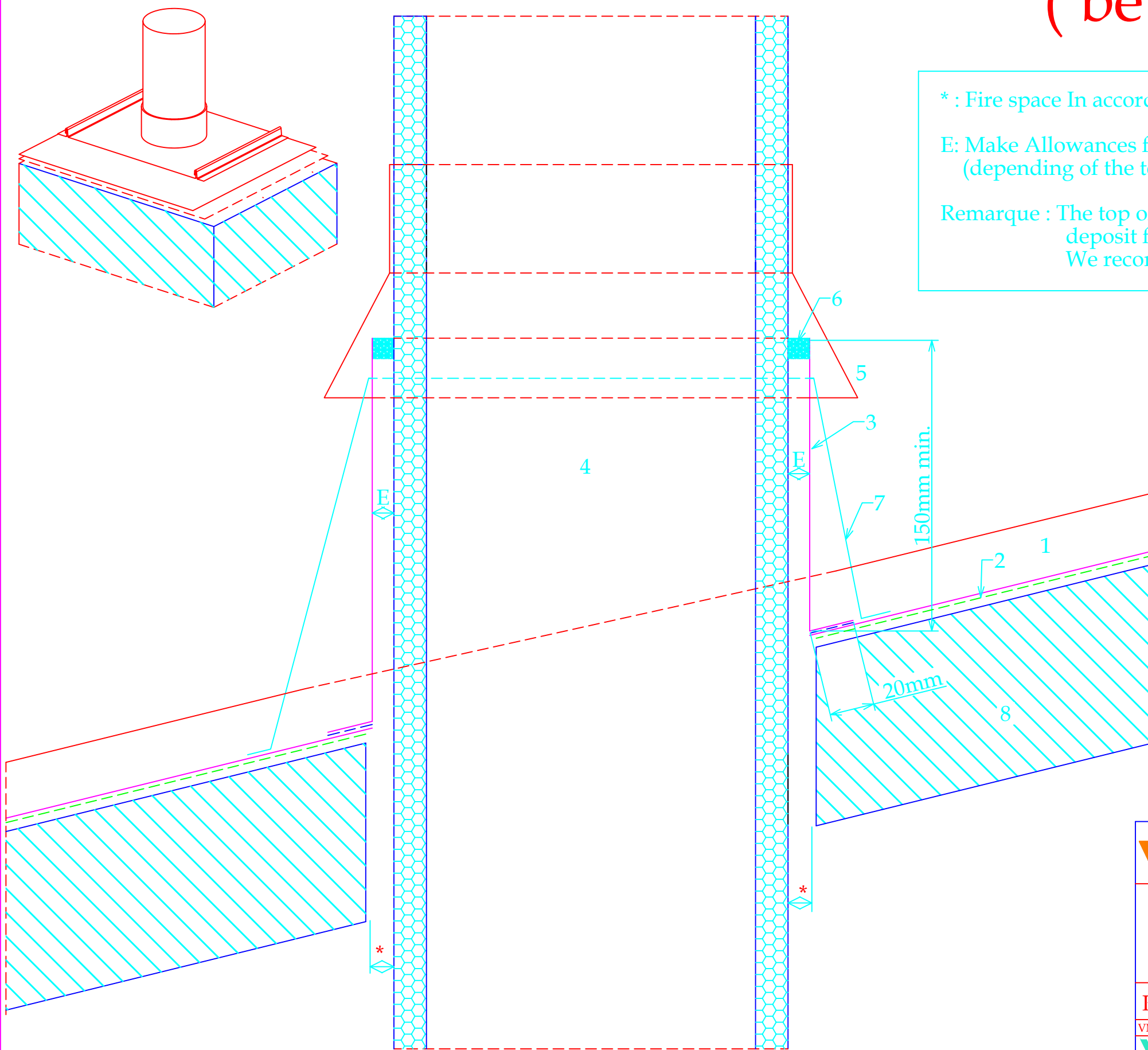

\* : Fire space In accordance with the building regulations

E: Make Allowances for the expansion & contraction of the VMZINC® (depending of the temperature when applied)

Remarque : The top of the chimney must be high enough to prevent deposit falling onto the roof.  
We recommend the use of a chimney/ flue cowl - conical

- 1. VMZ Standing Seam in VMZINC® PLUS
- 2.VMZINC Membrane
- 3. tube in VMZINC® PLUS
- 4. twinwall chimney in stainless steel with insulation
- 5. flashing piece in stainless steel
- 6. mastic sealant, compatible with VMZINC®
- 7. flashing collar in VMZINC® PLUS (dot soldering)
- 8. insulated metal panel, in accrodance with specifications.



STANDARD DETAIL

Ref : VMZ-SN-CP-DDB-b1 Date : 2022

VM Building Solutions UK Collier House, Mead Lane, Hertford, SG13 7AX Tel: 0203.445.5640

VM BUILDING SOLUTIONS